



Part Number
PB-SK-15
PB-SK-20
Patent: US 9,194,148 B1

PoolBond PB-SK Skimmer Follow and Save these Instructions

Step 1: Install Skimmer Plug

For proper sealing, apply o-ring lubricant to the plug o-ring(5). From the top of the skimmer, install the skimmer plug(4) and plug o-ring(5) into the normally plugged skimmer port using a short screwdriver. The screwdriver blade should be long enough to span the castle grooves in the top of the plug. Tighten approximately 1/4 turn after the o-ring contacts the skimmer.

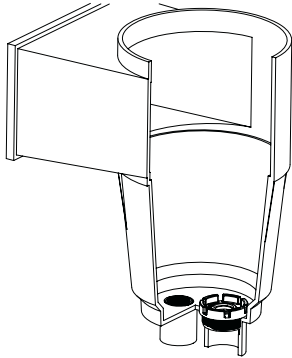

Step 2: Connect PoolBond to Bonding Wire

From the bottom of the skimmer, bring the bonding wire through the center of the skimmer plug(4) up to the top of the skimmer. Insert the fitting o-ring(3) over the bonding wire and place the o-ring(3) on the top surface of the skimmer plug(4). Use the split bolt to attach the bonding wire to the PoolBond fitting(1). Always use 2 wrenches to tighten the split bolt as shown in the illustration. Make sure the end of the bonding wire does not extend beyond the edge of the PoolBond fitting. Place a sharp bend in the bonding wire as shown.

Important:

When bending wire around the split bolt, keep the wire within the boundary of the fitting finger as shown below.

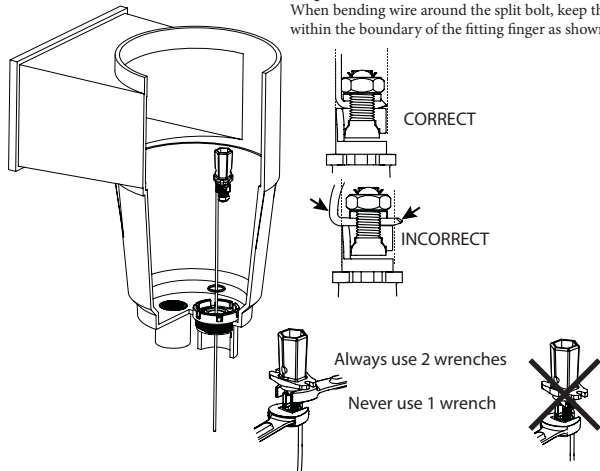

Step 3: Install the Fitting O-Ring

Apply o-ring lubricant to the Fitting O-Ring (3) and insert it into

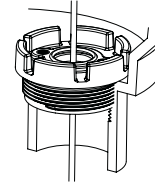

Step 4: Install the PoolBond Fitting

Insert the PoolBond Fitting into the skimmer plug(4) and fitting o-ring (3) installed at the bottom of the skimmer. Using a Phillips screwdriver, connect the PoolBond fitting to the skimmer plug as show. Tighten each screw about 1/4 turn until the PoolBond fitting seats against the top of the skimmer plug(4). Do not over tighten these screws. Over tightening these screws can result in damage to the skimmer plug. Installation is complete.

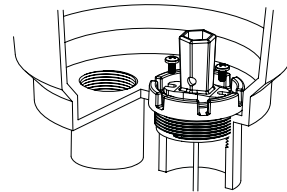

Installation Suggestion:

Under normal circumstances, the PoolBond fitting will last the life of the pool. If service of the PoolBond fitting becomes necessary, excess bonding wire stored below the skimmer will make service to the PoolBond a simple task. The illustration below shows a simple method to store excess bonding wire below the skimmer.

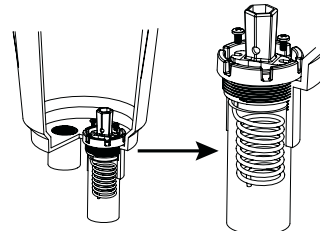

1. PB2008 Skimmer Fitting
2. 10-24 Stainless Steel Screw x2
3. Fitting O-Ring
4. Skimmer Plug

5. Plug O-Ring
6. Split Bolt Connector

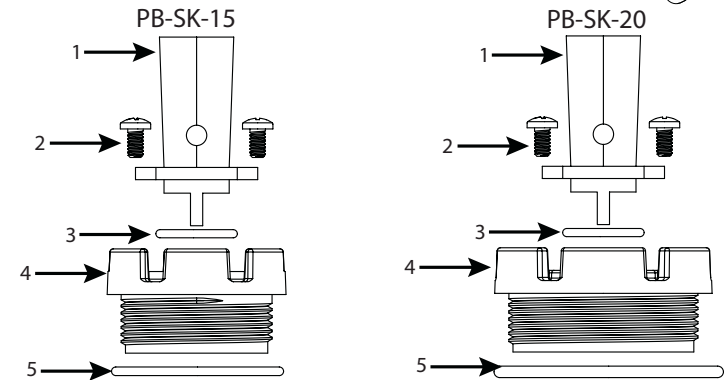
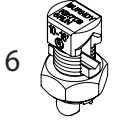

Surface Area - Water Bonding Specifications

The 2008 National Electrical Code (NEC) requires that an intentional electrical bond of a minimum conductive surface area of 9 square inches be installed and in contact with the swimming pool water. This requirement is spelled out in Section 680.26(C). PoolBond PB-2008-SK meets the specifications spelled out by the NEC.



Outside Face
Surface Area
 $(5*1.6)*(46+.53) = .792$
 $.792*6\text{ Sides} = 4.752$



Inside Face
Surface Area
 $(5*1.7)*(33+.40) = .6205$
 $.5475*6\text{ Sides} = 3.723$



Inside Top Face
Surface Area Rectangle
 $.33*.58 = .1914$
Surface Area Triangle
 $.58*.5*.167 = .048$
 $.048*2\text{ Sides} = .096$

Total = 4.752

Total = 3.723

Total = .287

Outside Face = 4.752
Inside Face = 3.723
In. Top Face = .287
See Note = 1.808

Total Sq. In. = 10.57

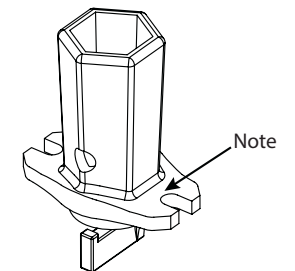

Note: Area for Fillets and outside face not shown.
However total surface area is an additional 1.808 Sq. In.